

**P.C.B LAYOUT  
TOP VIEW**

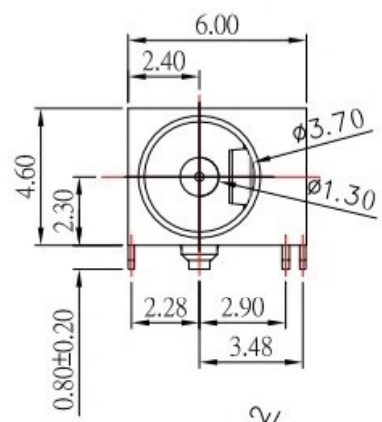

**SPECIFICATION**

1. Rating : DC 12V, 3.0A ;
2. Contact resistance : ≤ 30mΩ ;
3. Insulation resistance : ≥ 100MΩ ;
4. Withstand voltage : 500VAC ;
5. Insertion and extraction force : 3-20N
6. life test : 5,000 cycles °

MODEL NO.	DC-S060-1.3
SCHEMATIC	



NO.	DESCRIPTION	QTY	MATERIAL	PLATING
⑥	STOPPER	1	SUS	N/A
⑤	CONTACT FOOT	1	BRASS	Ag-Plating
④	PIN	1	BRASS	Ni-Plating
③	CURVE PIECE	1	BRASS	Ag-Plating
②	SPRING	1	PHOSPHOR BRONZE	Ag-Plating
①	HOUSING	1	PA9T	

**东莞市高迪电子有限公司**  
Dong Guan KDRR Electronic Switch Jack Co., Ltd.

ITEM NO.	DESCRIPTION	DRAWN	DATE
1	更新圖面樣式和標圖	Jack	12/11/19

TOLERANCE UNLESS OTHERWISE STATED

Up to 5	±0.2
Above 5 - 15	±0.3
Above 15 - 30	±0.4
Above 30 - 50	±0.5
Angle	±0.3°

3RD. ANGEL'S

UNITS MM

DRAWN BY:	DATE	MAT'L	TITLE	JACK
Jack Lu	12/11/19			
CHECKED BY:	DATE	FINISH	MODLE	DC JACK
Jacky Chen	12/11/19			
APPROVED BY:	DATE	SCALE	DWG NO.	DC-S060-1.3-S124
Tony Kao	12/11/19	1 : 1	PART NO.	DC-S060-1.3-S124
		SHEET NO.	1 of 1	
		SIZE	A4	
		VER	R1	